



DIC ATEX



DIC INOX ATEX
Adatto per aria corrosiva / acida
Suitable for corrosive / acid air

DIC ATEX - DIC INOX ATEX

Aspiratori centrifughi pale avanti Forward curved blade centrifugal fans



Zone 1 II2G Ex h IIB T4 Gb
GAS

DESCRIZIONE

Gli aspiratori centrifughi della serie DIC ATEX e DIC INOX ATEX sono costruiti e certificati in conformità alla Direttiva ATEX 2014/34/UE. Sono specificatamente progettati per essere utilizzati in zona 1, ossia in aree o ambienti dove sia necessario garantire un elevato fattore di sicurezza contro le esplosioni dovute alla presenza di gas, vapori, nebbie (II2G). Il loro impiego è previsto per convogliare aria pulita con temperature comprese in un range da -20°C a +60°C (su richiesta, da -40°C a +60°C). Trovano il loro impiego in tutte quelle applicazioni industriali dove siano richiesti piccoli volumi d'aria con alte pressioni. La serie è costituita da modelli con diametro girante da 100 a 180 mm. La cassa è facilmente orientabile, anche in sito, ogni 45°, compresi gli angoli 180° e 225°. DIC INOX ATEX è realizzato in acciaio Inox AISI 304 e adatto per convogliare aria corrosiva e/o acida.

COSTRUZIONE

- Cassa a spirale realizzata in lamiera d'acciaio protetta contro gli agenti atmosferici con vernici a polveri epossipoliestriche oppure in acciaio inossidabile AISI304.
- Girante a semplice aspirazione con pale curve in avanti (sirocco), a spessore costante, realizzata in lamiera zincata oppure in acciaio inossidabile AISI304.
- Boccaglio in lamiera verniciata (DIC ATEX) o inox (DIC INOX ATEX).
- Esecuzione 5, (accoppiamento diretto con girante a sbalzo su motore flangiato).
- Motore separato dal flusso di aria convogliata.
- Orientamento standard LG 270°.
- Raccordo in aspirazione fornito in dotazione (non montato).

MOTORE

Motore antideflagrante asincrono trifase o monofase a norme internazionali IEC 60034, IEC 60072, ATEX 2014/34/UE, EMC 2014/30/UE, LVD 2014/35/UE, marcato CE, IP55 secondo la EN ISO 20653, classe F. Idoneo ad un servizio continuo (S1). Specificamente progettato per installazione in ambienti classificati come zona ATEX 1 II2G (GAS) IIB, apparecchiature protette mediante custodie a prova d'esplosione "db" in accordo allo standard CEI EN IEC 60079-0, CEI EN 60079-1. Motore dotato di sistema di protezione da sovratemperatura con termistori tipo PTC conformi alle norme DIN 44081, DIN 44082, IEC 60034-11-2 e idoneo alla regolazione di velocità a mezzo di regolatore tipo inverter (per la versione trifase).

ACCESSORI

- Sedia portamotore lamiera / inox
- Rete di protezione per bocca aspirante e premente realizzata a norma uni 12499 e protetta contro gli agenti atmosferici
- Raccordo per bocca premente.

DESCRIPTION

The centrifugal fans of the DIC ATEX and DIC INOX ATEX series are built and certified in compliance with the ATEX Directive 2014/34/UE. They are specifically designed to be used in zone 1, i.e. in areas or environments where it is necessary to guarantee a high safety factor against explosions due to the presence of gases, vapors, mists (II2G). They are suitable to convey clean air with a temperature included in a range from -20°C to +60°C (on request, from -40°C to +60°C). They are ideal for all the industrial applications where small air volumes and high pressures are required. The casing is easily adjustable, also on site, to the required discharge angle every 45°, including orientations 180° and 225°. DIC INOX ATEX is made of stainless steel AISI304 and is suitable for conveying corrosive / acid air.

CONSTRUCTION

- Volute casing in steel sheet, protected against atmospheric agents by epoxy paint or in stainless steel AISI304 sheet.
- Single inlet, single gauge, forward curved impeller (sirocco type), in galvanized steel sheet or in stainless steel AISI304.
- Steel sheet inlet with epoxy finish (DIC ATEX) or inox (DIC INOX ATEX).
- Execution 5 (with impeller directly coupled to flanged motor).
- Motor separated from the conveyed airflow.
- Standard orientation LG270°.
- Inlet connector supplied (disassembled).

MOTOR

Explosion-proof asynchronous three-phase or single-phase motor compliant with international standards IEC 60034, IEC 60072, ATEX 2014/34/UE, EMC 2014/30/UE, LVD 2014/35/UE, CE marked, IP55 according to EN ISO 20653, class F. Suitable for continuous duty (S1). Specifically designed for installation in environments classified as ATEX zone 1 II2G (GAS) IIB, equipment protected by flame-proof enclosures "db" according to CEI EN IEC 60079-0, CEI EN 60079-1 standard. The motor includes an overtemperature protection system equipped with PTC thermistors in accordance with DIN 44081, DIN 44082, IEC 60034-11-2 and suitable for speed regulation by inverter-type controller (for three-phase version).

ACCESSORIES

- Motor support in steel or steel sheet
- Inlet and outlet protection guard manufactured according to UNI 12499 norm and protected against the atmospheric agents
- Outlet connector.

NORME | NORMS

EN 14986:2017
EN 1127-1
EN ISO 80079-36
EN ISO 80079-37

Attestato di Esame del Tipo
Type Examination Statement 
IMQ 10 ATEX 018 X

A RICHIESTA UPON REQUEST

- Versioni a 60 Hz
- Classi di temperatura T5 e T6
- Versions at 60 Hz
- Temperature classes T5 and T6

VERSIONI | VERSIONS



DIC ATEX - DIC INOX ATEX
Zone 21
II2D Ex h IIB T135°C Db
DUST



DIC ATEX | DIC INOX ATEX
Zone 1
II2G Ex h IIB+H2 T4 Gb
HYDROGEN

PRESTAZIONI | PERFORMANCE

DIC ATEX | DIC INOX ATEX

Le prestazioni aerauliche sono rilevate in conformità alla norma EN ISO 5801/AMCA 210 con densità dell'aria standard avente peso specifico 1,2 Kg/m³. Il livello di potenza sonora è ottenuto secondo la norma AMCA 300-08 in camera riverberante. Installazione D.
Le tolleranze sono conformi alla ISO 13348 e alla DIN 24166. Alimentazione 230V/1Ph/50Hz o 400V/3Ph/50Hz.

Air performances are measured according to EN ISO 5801 / AMCA 210 standard with air density with 1.2 kg/m³ specific weight. The sound power level is obtained according to AMCA 300-08 in reverberating room. Installation D.
Tolerances comply with ISO13348 and DIN 24166. Power supply 230V/1Ph/50Hz or 400V/3Ph/50Hz.

DIC ATEX | DIC INOX ATEX 100

Code	Tipo Type	Modello Model	U	P	Pm (kW)	In (A)	IP/CL	IE3	Mot. (Gr)
1XD1048	DIC ATX	100	M	2	0,06	0,80	55/F	-	56
1XD1050	DIC INOX ATX								
1XD1049	DIC ATX	100	T	2	0,09	0,53	55/F	-	56
1XD1051	DIC INOX ATX								

LIVELLI SONORI | SOUND LEVELS dB(A)

Hz		63	125	250	500	1000	2000	4000	8000	TOT
100/2	LwA	45	57	62	66	71	64	56	46	73
	Lp	34	46	51	55	60	53	45	35	62

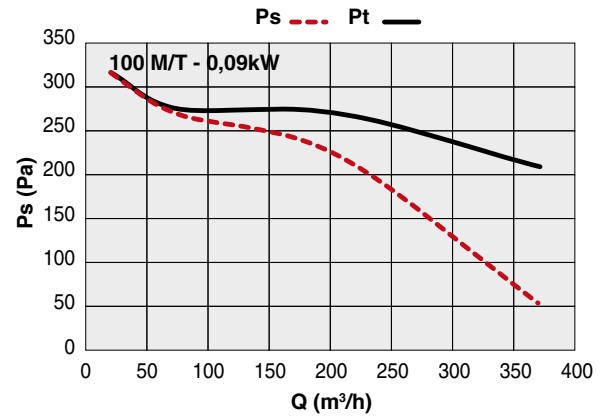

DIC ATEX | DIC INOX ATEX 120

Code	Tipo Type	Modello Model	U	P	Pm (kW)	In (A)	IP/CL	IE3	Mot. (Gr)
1XD1299	DIC ATX	120	M	2	0,25	2,20	55/F	-	63
1XD1301	DIC INOX ATX								
1XD1300	DIC ATX	120	T	2	0,25	0,62	55/F	-	63
1XD1302	DIC INOX ATX								

LIVELLI SONORI | SOUND LEVELS dB(A)

Hz		63	125	250	500	1000	2000	4000	8000	TOT
120/2	LwA	44	54	68	73	69	74	69	65	78
	Lp	33	43	57	62	58	63	58	54	67

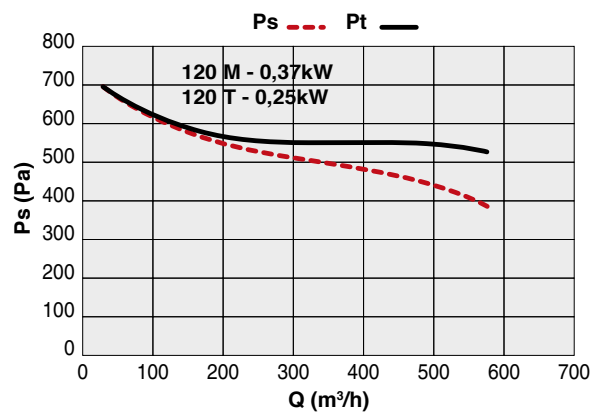

DIC ATEX | DIC INOX ATEX 140

Code	Tipo Type	Modello Model	U	P	Pm (kW)	In (A)	IP/CL	IE3	Mot. (Gr)
1XD1455	DIC ATEX	140	M	2	0,37	2,50	55/F	-	71
A RICHIESTA UPON REQUEST DIC INOX ATEX									
1XD1456	DIC ATEX	140	T	2	0,37	0,90	55/F	-	71
1XD1457 DIC INOX ATEX									

LIVELLI SONORI | SOUND LEVELS dB(A)

Hz		63	125	250	500	1000	2000	4000	8000	TOT
140/2	LwA	52	60	75	77	77	78	76	70	84
	Lp	41	49	64	66	66	67	65	59	73

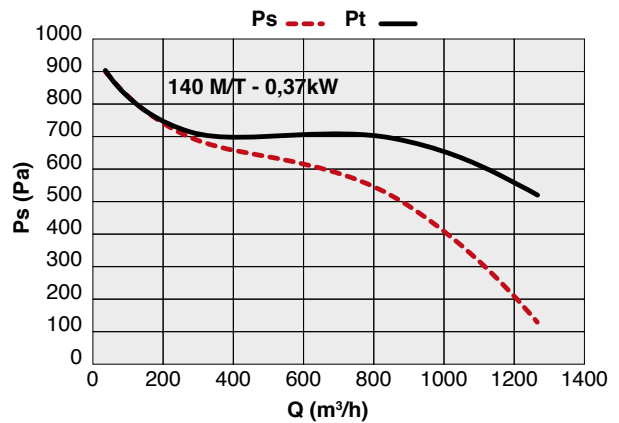

DIC ATEX | DIC INOX ATEX 160

Code	Tipo Type	Modello Model	U	P	Pm (kW)	In (A)	IP/CL	IE3	Mot. (Gr)
1XD1657	DIC ATX	160	T	2	0,75	1,80	55/F	✓	80
1XD1658 DIC INOX ATX									

LIVELLI SONORI | SOUND LEVELS dB(A)

Hz		63	125	250	500	1000	2000	4000	8000	TOT
160/2	LwA	53	64	79	81	82	83	81	75	89
	Lp	42	53	68	70	71	72	70	64	78

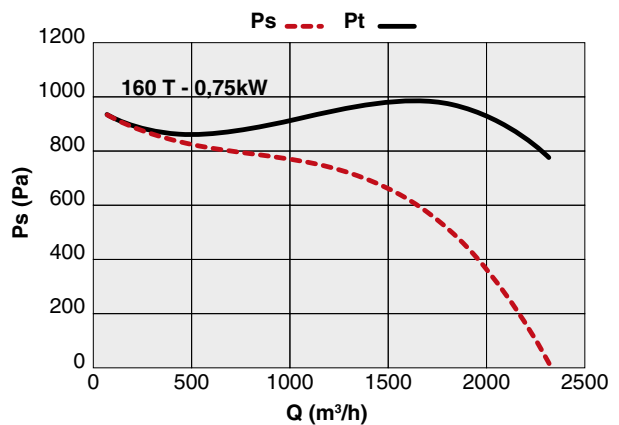

DIC ATEX | DIC INOX ATEX 180

Code	Tipo Type	Modello Model	U	P	Pm (kW)	In (A)	IP/CL	IE3	Mot. (Gr)
1XD1831	DIC ATX	180	T	2	1,10	2,40	55/F	✓	80
1XD1832 DIC INOX ATX									

LIVELLI SONORI | SOUND LEVELS dB(A)

Hz		63	125	250	500	1000	2000	4000	8000	TOT
180/2	LwA	61	71	83	85	87	86	84	78	92
	Lp	50	60	72	74	76	75	73	67	81

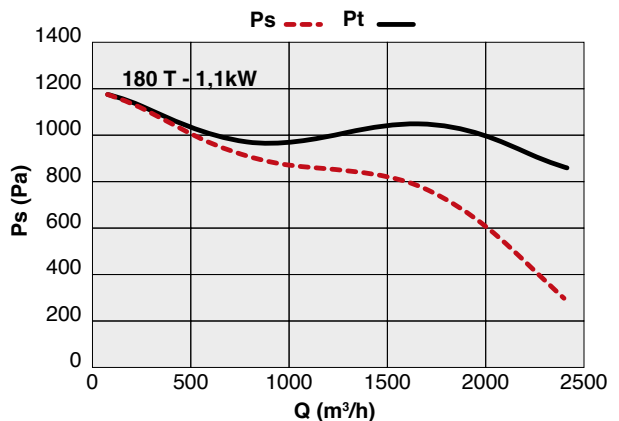

DIMENSIONI | DIMENSIONS mm

DIC ATEX | DIC INOX ATEX

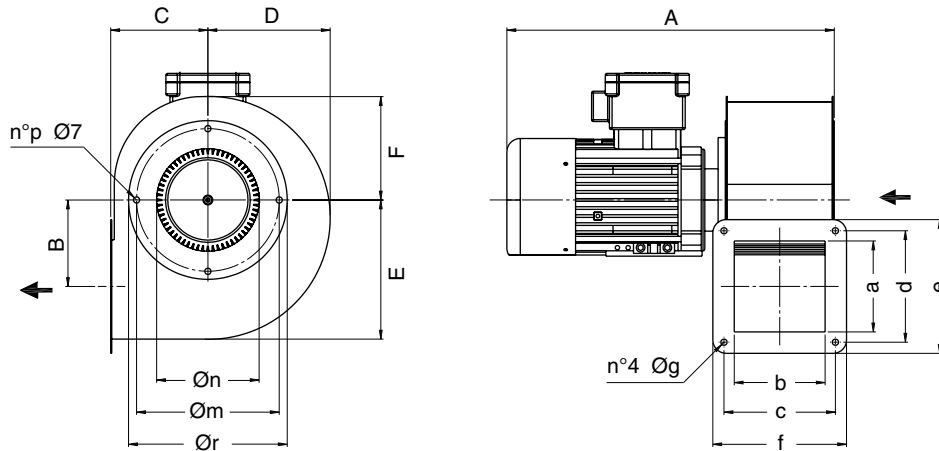

DIC ATEX | DIC INOX ATEX

TIPO TYPE	A	B	C	D	E	F	a	b	c	d	e	f	Øg	Øm	Øn	n°p	Ør
100	289	82	86	112	130	99	76	84	105	95	115	125	6	130	90	4	145
120	367	97	109	137	156	116	102	102	125	125	150	150	7	160	115	4	178
140	380	115	126	158	184	136	118	118	148	148	175	175	8	180	135	4	195
160	410	132	143	175	207	148	135	135	165	165	195	195	8	222	155	8	240
180	414	140	156	200	227	171	148	148	180	180	210	210	8	222	170	8	240

*La sedia portamotore è un accessorio. Il modello 100 monta un motore a forma B14, quindi senza piedini
 The motor support is an accessory. Model 100 has a motor shape B14, thus without feet

RACCORDO ASPIRANTE | INLET ADAPTOR



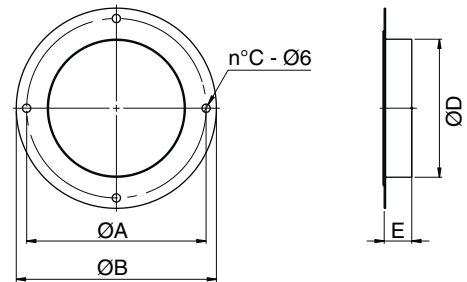

TIPO TYPE	ØA	ØB	C	ØD	E	Kg
100	130	145	4	100	20	0.2
120	160	180	4	125	20	0.2
140	180	200	4	125	30	0.4
160	222	238	8	160	40	0.4
180	222	238	8	160	40	0.4

Pesi indicativi | Indicative weights

N.B.: Raccordo in aspirazione fornito non montato
 Inlet adaptor supplied, not assembled

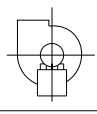

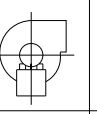
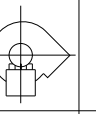
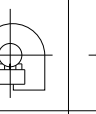
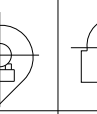
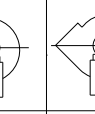
ORIENTAMENTO | DISCHARGE ANGLE

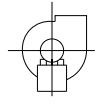
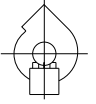
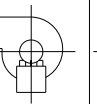
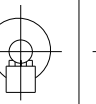
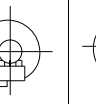
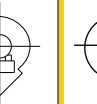
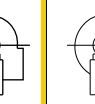
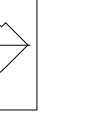
Rotazione Rotation RD								
Forma Form	0°	45°	90°	135°	180°	225°	270°	315°
Rotazione Rotation LG								

N.B.: Orientamento standard LG 270° - Orientamenti LG 45°, 135°, 225° e 315° non disponibili per DIC 100 e 120.

Standard discharge angles LG 270° - Discharge angles LG 45°, 135°, 225° e 315° not available on DIC 100 and 120.



SEDIA PORTAMOTORE | MOTOR SUPPORT

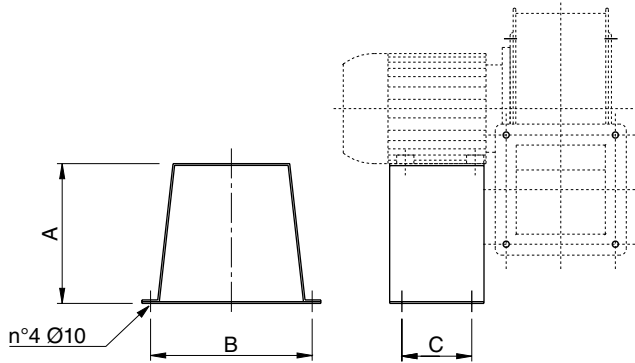

Code DIC ATEX	Code DIC INOX ATEX	Tipo Type	A	B	C	Kg
1SE6007		100	120	140	71	0,5
1SE6005		120	160	185	80	1,0
1SE6017		140	152	185	90	2,0
1SE6006	a richiesta upon request	160 - 180 grandezza motore 80 motor size 80	180	230	100	2,5
1SE6016		160-180 grandezza motore 90 motor size 90	170	230	100	3,0

Dimensioni in mm - Pesi indicativi | Dimensions in mm - Indicative weights

RETE BOCCA PREMENTE | OUTLET GUARD

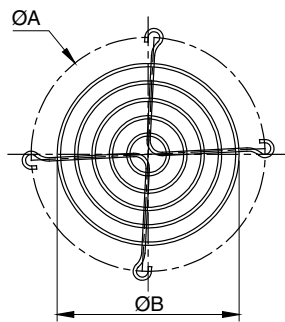

Code DIC ATEX	Code DIC INOX ATEX	Tipo Rete Guard Type	ØA	ØB	Kg
5RE0109	5RE1109	100	142	110	0,06
5RE0111	5RE1111	120	177	131	0,12
5RE0113	5RE1113	140	209	152	0,13
5RE0115	5RE1115	160	233	194	0,15
5RE0117	5RE1117	180	255	194	0,2

Dimensioni in mm - Pesi indicativi | Dimensions in mm - Indicative weights

RETE BOCCA ASPIRANTE | INLET GUARD

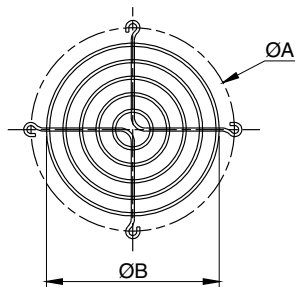

Code DIC ATEX	Code DIC INOX ATEX	Tipo Rete Guard Type	ØA	ØB	Kg
5RE1500	5RE1511	100	130	110	0,06
5RE1501	5RE1512	120	160	131	0,12
5RE1502	5RE1513	140	180	152	0,12
5RE1503	5RE1509	160-180	222	194	0,15

Dimensioni in mm - Pesi indicativi | Dimensions in mm - Indicative weights

RACCORDO BOCCA PREMENTE | OUTLET CONNECTOR

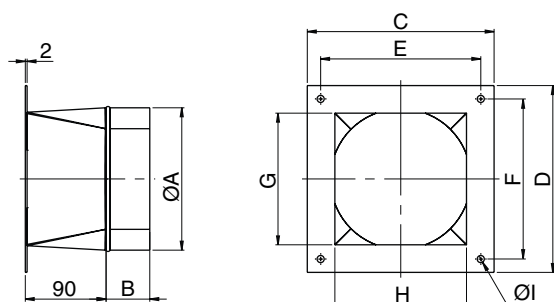

Code	Tipo Rete Guard Type	ØA	B	C	D	E	F	G	H	ØI	Kg
5RD1100	100	100	20	125	115	105	95	76	84	6	0,50
5RD1120	120	125	50	150	150	125	125	102	102	7	0,75
5RD1140	140	125	50	175	175	148	148	118	118	8	0,85
5RD1160	160	160	50	195	195	165	165	135	135	8	1,00
5RD1180	180	160	50	210	210	180	180	148	148	8	1,10

Dimensioni in mm - Pesi indicativi | Dimensions in mm - Indicative weights